

料号: BB51024W-RXX-XX-32
P/N: BB51024W-RXX-XX-32

REV	ECN MARK	DESCRIPTION	DATE
A1	△	产品料号修正	2022-7-19

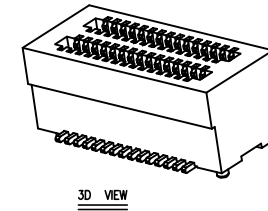
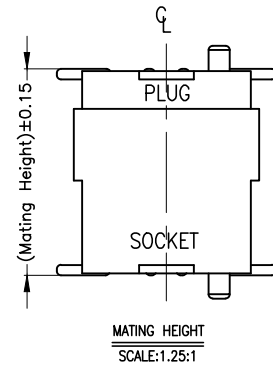
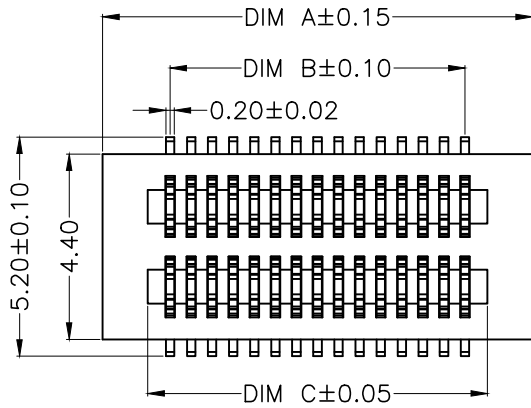

- NOTES:
- Housing: PA9T High-temp Thermoplastic UL94V-0 Color: Black
 - Terminal: Phosphor Bronze
Plating: 1U" Gold Flash
Overall 50~100U" Nickel Under Plated.
 - Voltage Rating: 60V DC
 - Current Rating: 0.5A MAX. (EACH PIN)
 - Operating Temperature: - 25°C TO +85°C

Ordering Information
BB5102 4 W - R ** - ** - 32

- ① ② ③ ④ ⑤ ⑥
- ①: BB5102: Series No
 - ②: 4: R/A SMT Type
 - ③: W: Socket
 - ④: R: RoHS
 - ⑤: PIN POS:
04:4Pos~100:100Pos
 - ⑥: Height: 22-H2.2 30-H3.0 35-H3.5
40-H4.0 45-H4.5

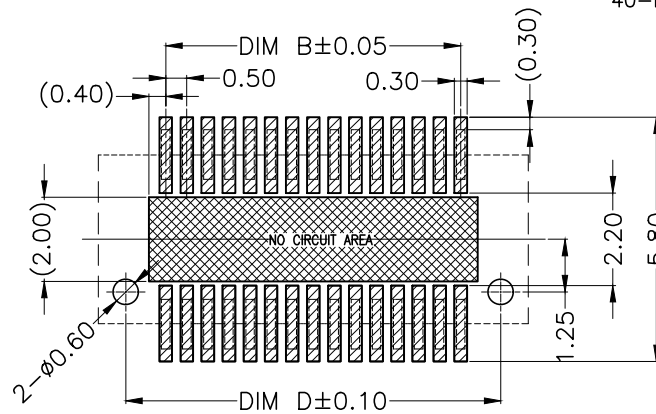
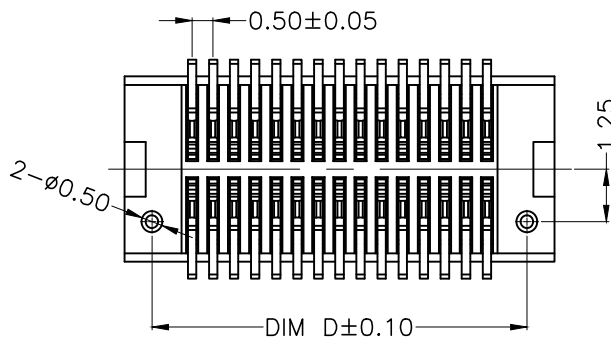
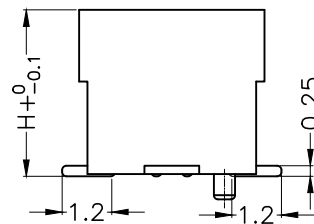
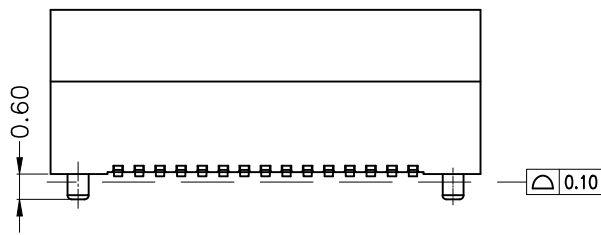

RECOMMENDED PCB PATTERN DIM.
TOLERANCE : ± 0.05

PIN	A	B	C	D
4	3.70	0.50	1.56	2.40
6	4.20	1.00	2.06	2.90
8	4.70	1.50	2.56	3.40
10	5.20	2.00	3.06	3.90
12	5.70	2.50	3.56	4.40
14	6.20	3.00	4.06	4.90
16	6.70	3.50	4.56	5.40
18	7.20	4.00	5.06	5.90
20	7.70	4.50	5.56	6.40
22	8.20	5.00	6.06	6.90
24	8.70	5.50	6.56	7.40
26	9.20	6.00	7.06	7.90
28	9.70	6.50	7.56	8.40
30	10.20	7.00	8.06	8.90
32	10.70	7.50	8.56	9.40
34	11.20	8.00	9.06	9.90
36	11.70	8.50	9.56	10.40
38	12.20	9.00	10.06	10.90
40	12.70	9.50	10.56	11.40
42	13.20	10.00	11.06	11.90
44	13.70	10.50	11.56	12.40
46	14.20	11.00	12.06	12.90
48	14.70	11.50	12.56	13.40
50	15.20	12.00	13.06	13.90
52	15.70	12.50	13.56	14.40
54	16.20	13.00	14.06	14.90
56	16.70	13.50	14.56	15.40
58	17.20	14.00	15.06	15.90
60	17.70	14.50	15.56	16.40
62	18.20	15.00	16.06	16.90
64	18.70	15.50	16.56	17.40
66	19.20	16.00	17.06	17.90
68	19.70	16.50	17.56	18.40
70	20.20	17.00	18.06	18.90
72	20.70	17.50	18.56	19.40
74	21.20	18.00	19.06	19.90
76	21.70	18.50	19.56	20.40
78	22.20	19.00	20.06	20.90
80	22.70	19.50	20.56	21.40
82	23.20	20.00	21.06	21.90
84	23.70	20.50	21.56	22.40
86	24.20	21.00	22.06	22.90
88	24.70	21.50	22.56	23.40
90	25.20	22.00	23.06	23.90
92	25.70	22.50	23.56	24.40
94	26.20	23.00	24.06	24.90
96	26.70	23.50	24.56	25.40
98	27.20	24.00	25.06	25.90
100	27.70	24.50	25.56	26.40

MATING HEIGHT	PLUG(H.)	SOCKET(H.)
3.0	0.8	2.2
3.5	1.3	2.2
4.0	1.0	3.0
4.5	1.0	3.5
5.0	1.0	4.0
5.5	1.0	4.5
6.0	2.0	4.0
6.5	2.0	4.5

JRE 深圳市锦润电子科技有限公司
SHENZHEN JINRUN ELECTRONICS TECHNOLOGY CO.,LTD

比例 SCALE 1:1
单位 UNIT mm

一般公差 GENERAL TOLERANCE
*** ± 0.05 | ± 0.5°
** ± 0.15 | ± 1°
* ± 0.25 | ± 2°
--- ± 3°

投影法 PROJECTION METHOD
第一角投影法

绘图 DR. ZHENG ZEHUI
2015-11-18

校图 CHK. S K Y

核准 APPD. QI JIANHUA
2015-11-18

版本: REV. A
页码: PAGE 1 of 1

品名: BTB0.5Pitch Double Slot Socket
料号: BB51024W-RXX-XX-32
P/N: